

P6K-30-SERIES-5BB



156.75P



18.8%

Average cell efficiency up to 18.8%
Excellent optical performance

0-5w

Positive tolerance 0~5W
Reliability for output performance

12
Years

12 years for product
25 years linear Warranty

Grid

Residential roof top systems
On/Off-grid commercial systems
On/Off-grid utility systems

3rd

TUV Class C fire class rating
TUV 5400Pa for Snow Load Test
TUV 2400Pa for Wind Load Test
CSA Type 1 fire class rating
CSA Mechanical Load=1.5×3600Pa=5400Pa

Certification

IEC 61215(Edition 2005), IEC 61730
ULC/ORD-C 1703-01, UL 1703-3rd Edition
ISO9001:2008, ISO14001:2004

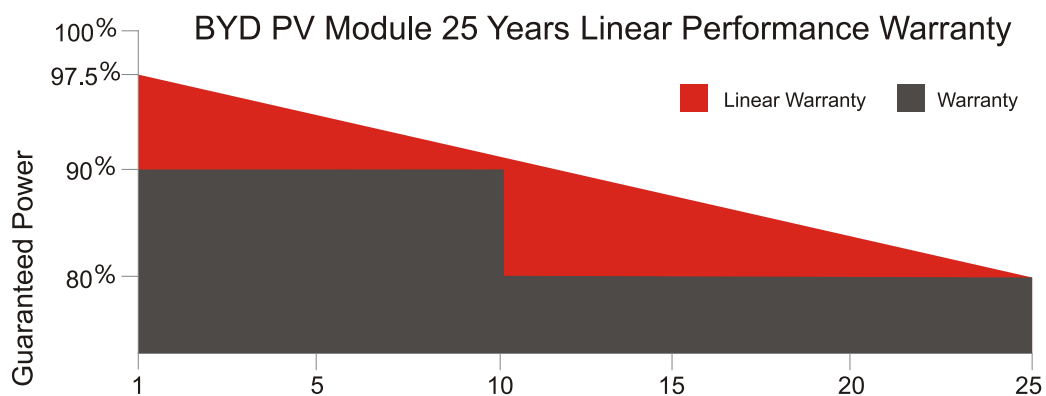

ABOUT BYD

BYD (HK:1211), one of the world's top PV manufacturers, produces from wafer to module, committing to high quality sustainable products and continuous improvement. Integrating with Electrical Vehicles and Battery Energy Storage technology makes BYD the world-leading solution provider from energy generating to consumption and storage.

P6K-30-SERIES-5BB

265-280W

156.75P

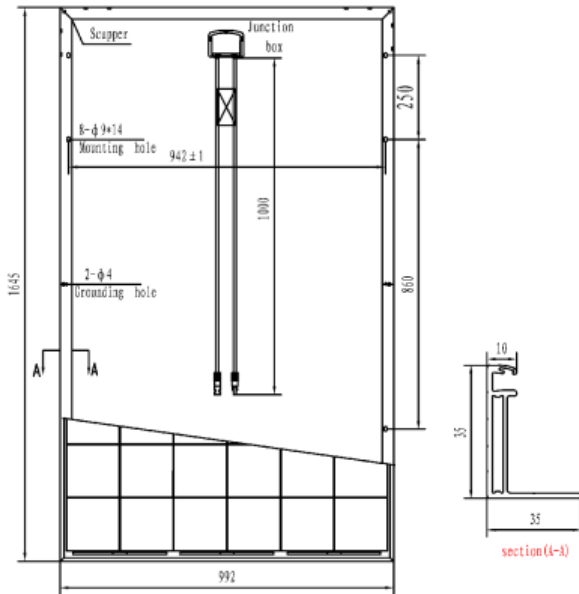

MECHANICAL SPECIFICATIONS

Cell	Poly-crystalline 156.75×156.75mm / 6.17 inch
No. of Cells	60 (6×10) pcs
Dimension of Module	1645×992×35mm / 62.31 inch×39.06 inch×1.38 inch
Weight	18.7 kg / 41.14 lbs
Front Glass	3.2 mm tempered glass with AR Coating
Frame	Anodized aluminum alloy
Junction Box	IP67
Plug Connector	IP67
Bypass-Diodes	3 pcs
Type of Connector	MC4-compatible
Cable Section Area	4 mm ² / 0.0062 Sq in
Cable Length	2×1000 mm / 2×39.4 inch

TEMPERATURE COEFFICIENTS

Nominal Operating Cell Temperature (NOCT)	45°C
Short-Circuit Current Temperature Coefficient	0.07%/°C
Open-Circuit Voltage Temperature Coefficient	-0.31%/°C
Peak Power Temperature Coefficient	-0.39%/°C

PACKAGE INFORMATION

Package	40' HC
Pcs / Pallet	30
Pallet / Container	28
Pcs / Container	840

STC

Module Type	265 P6K-30	270 P6K-30	275 P6CK-30	280 P6K-30
Open Circuit Voltage (Voc)	38.69 V	39.00 V	39.31 V	39.62 V
Maximum Operating Voltage (Vmp)	30.93 V	31.18 V	31.43 V	31.68 V
Short Circuit Current (Isc)	9.05 A	9.13 A	9.21 A	9.29 A
Maximum Operating Current (Imp)	8.57A	8.66 A	8.75 A	8.84 A
Maximum Power in STC (Pmax)	265 Wp	270 Wp	275 Wp	280 Wp
Module Efficiency	16.2%	16.5%	16.9%	17.2%
Operating Temperature	-40°C~85°C			
Max.Fuse Current Rating	15 A			
Maximum System Voltage	1500 VDC			
Power Tolerance	0~5 W			
Application Classes	Class A			

STC: IRRADIANCE 1000W/m², Module Temperature 25°C, AM=1.5 Ave. efficiency reduction of 3% at 200W/m²

NOCT

Module Type	265 P6K-30	270 P6K-30	275 P6K-30	280 P6K-30
Open Circuit Voltage (Voc)	35.70 V	36.00 V	36.30 V	36.60 V
Maximum Operating Voltage (Vmp)	28.60 V	28.8 V	29.10 V	29.10 V
Short Circuit Current (Isc)	7.34 A	7.40 A	7.47 A	7.53 A
Maximum Operating Current (Imp)	6.87 A	6.94 A	7.00 A	7.02 A
Maximum Power in STC (Pmax)	196.30 Wp	200.10 Wp	203.80 Wp	204.40 Wp

NOCT: open-circuit module operation temperature at 800W/m² irradiance, 20°C ambient temperature, 1m/s wind speed.



BYD SOLAR No.3009, BYD Road, Pingshan, Shenzhen, 518118, P.R.China

T +86-755-8988 8888

F +86-755-8420 2222

@ bydpv@byd.com

e www.byd.com/pv